

S44



AD boats Ltd.

Matoševa 8, Solin, Croatia
info@adboats.hr

tel. +385 21 206 855
fax. +385 21 206 539



salona

www.salonayachts.com

Sporty elegance and innovation

The new model of Salona range follows the success of the highly recognized Salona 45, the first model that has set the new standards in the range of performance cruisers. The fusion of style and sailing ability will make her appearance impressive at the first sight, but more important is the thing that lies behind her slender silhouette – an uncompromising construction.

Construction and technology

The hull and deck laminates are constructed with the use of epoxy based vinylester resin with triaxial and biaxial E-Glass fabrics adopting the latest infusion method. As a result, the Salona 44 is not only lighter, stronger and stiffer than the Salona 45 she replaces but she is also much faster. For further assurance of the integrity of the hull/keel/rig system, there is an integrated bonding of these critical components using a structural grid of stainless steel. This innovative stainless steel grid construction will give any skipper a complete confidence to take the Salona 44 across any ocean without fear of a failure.

Outside areas

As her predecessors, the Salona has kept her elegant open Mediterranean style combined with safety provided with the protected areas which make her suitable for Mediterranean winter sailing as well as for the North Sea conditions.

Interiors

Comfort and relaxation have been the guideline in design together with modern and high quality materials used in the interiors, which are offered in two different layouts.

Sailing/racing ability

The Salona 44 will prove to be not only a safe and luxury cruiser but also an exciting, competitive yacht under both the IRC and ORC racing rules. The Salona 44 offers a new level of refinement and sophistication which is accompanied with the ability to cruise in a relaxed, yet confident manner or to perform to the highest levels in both IRC and ORC regattas. The shipyard also offers expert advices for different handicap optimization with special racing oriented packages.

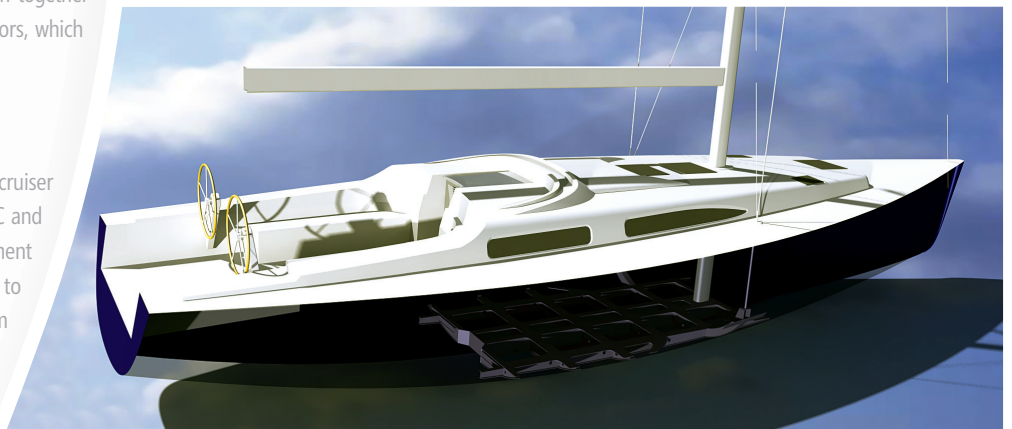

LOA (hull)	13,50 m
LWL	12,16 m
B. max. (deck)	4,19 m
Draft	2,10 / 2,55 m
DSPL empty	9.300 kg
Ballast	3.400 kg
I	16,71 m
J	5,12 m
P	16,68 m
E	6,00 m
Mainsail full batten	57,60 m ²
Genoa furling	61,10 m ²
Fresh water tank	400 l
Black water tank	42 l
Fuel tank	270 l
Engine	39.6 kW (54 HP)
Design Category	A - ocean

SALONA 44
LAYOUT A, 3 CABIN & 2 HEADS

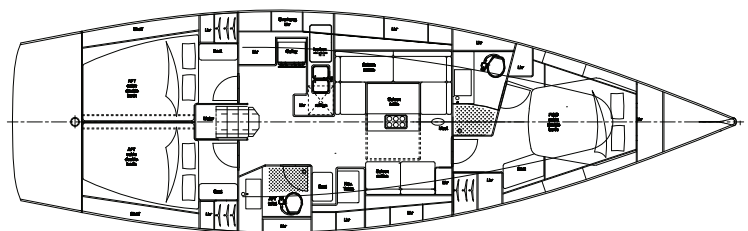

SALONA 44
LAYOUT B, 4 CABIN & 2 HEADS

